

# Roadway Lighting Luminaires - Cutoff Style Cobrahead with Power Door

200 - 400W HPS, 175 - 400W MV/MH

## PRODUCT OVERVIEW

### Features:

Rugged die-cast aluminum housing is powder-coated for durability and corrosion resistance. Die-cast secondary Power Pad door places all electrical components on one easily interchangeable module with quick disconnects to main fixture housing. Optional two-bolt mast arm mount provides easy, secure installation and adjustability for arms from 1-1/4" to 2" (32mm to 51mm) diameter. Standard four-bolt mounting provides extra security in high-vibration applications. Die-cast trigger latch on lens frame enables easy and secure one-hand opening for re-lamping. Star Friendly™ cutoff distribution patterns available. Large surface area "breathing seal" gasket seals the optical chamber to prevent intrusion by insects and environmental contaminants. Heat-resistant gasket material remains effective over the life of the fixture. Wildlife shield is cast into the housing (not a separate piece) with 2B option and is easily adjustable for 1-1/4" to 2" (32mm to 51mm) mast arms. Photocontrol receptacle is adjustable without tools. Anodized aluminum reflectors provide uniform lighting distribution with either flat or sag clear tempered glass. NEMA wattage label, terminal block, and NEMA photocontrol receptacle are standard. All electrical components warranted by American Electric Lighting's 6-year guarantee. Suitable for -30°C MH & MV / -40°C HPS. Complies with ANSI: C136.2, C136.10, C136.14, C136.15, C136.17, C136.31



### Applications:

- Roadways
- Residential streets
- Storage areas
- Parking lots
- Campuses
- Parks

#### 325 40S R3 FG

ISOILLUMINANCE PLOT (FC)

Mounting Height = 20 ft.

Classification: Type III, Medium, Cutoff

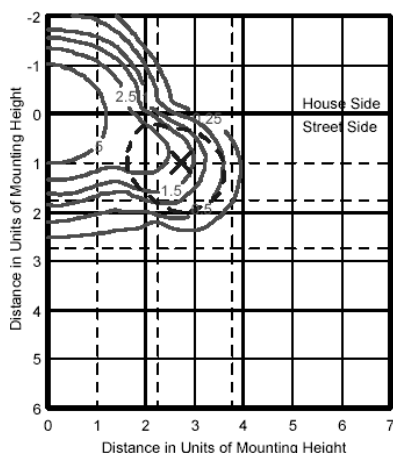

#### 325 40S R3 FG HP

ISOILLUMINANCE PLOT (FC)

Mounting Height = 20 ft.

Classification: Type III, Medium, Cutoff

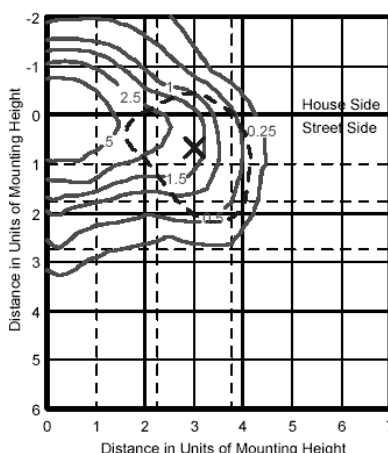

#### 325 40S R3 SG

ISOILLUMINANCE PLOT (FC)

Mounting Height = 20 ft.

Classification: Type II, Medium, Cutoff

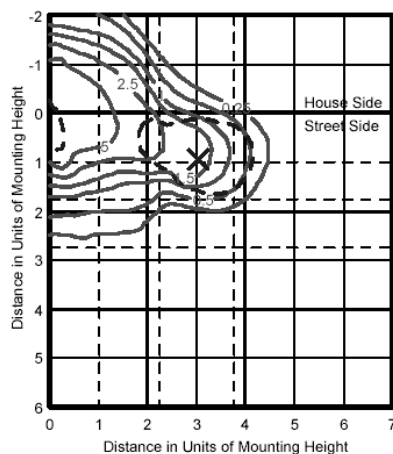

ISOILLUMINANCE PLOT (FC)

Mounting Height = 20 ft.

Classification: Type II, Medium, Cutoff

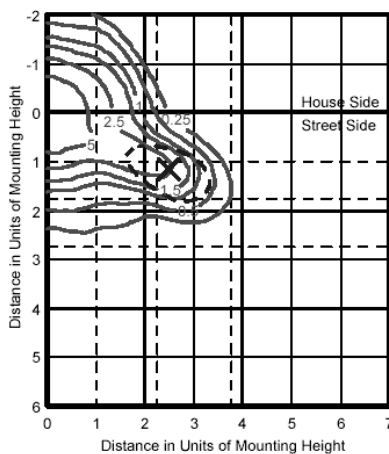

Maximum Intensity  
1/2 Maximum Intensity

### DIMENSIONS

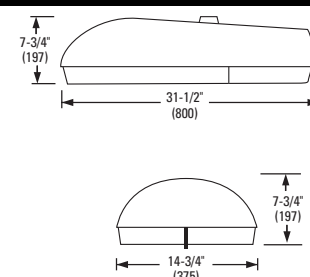

#### Effective Projected Area (EPA)

The EPA for the Horizontal Luminaire Series 325 is 1.14 sq. ft.  
Approx. Wt. = 35 lbs

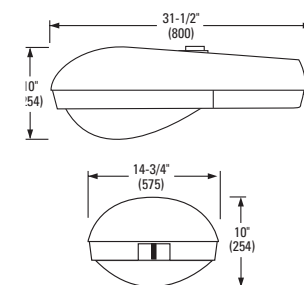

Effective Projected Area (EPA) The EPA for the Horizontal Luminaire Series 325 with sag glass is 1.22 sq. ft.

For Flat Glass Optics see Note 7 for Socket Location



# Roadway Series 325

## Roadway Lighting Luminaires — Cutoff Style Cobrahead with Power Door

200-400W HPS, 175-250W MV/MH

### ORDERING INFORMATION

Example: 325 31S CA MT1 R3 FG SF BL

Series	Wattage / Source		Ballast	Voltage	Distribution
325 Power Door Cobrahead	17	175W	<b>S</b> HPS	<b>120</b> 120V	<b>R2</b> Roadway Type II <b>R3</b> Roadway Type III  <i>Refer to Optical Matrix below for compatibility</i>
	20	200W	<b>M</b> MH	<b>208</b> 208V	
	25	250W	<b>V</b> MV	<b>220</b> 220V	
	31	310W		<b>240</b> 240V	
	40	400W		<b>277</b> 277V	
	23	250/400W wired 250W		<b>347</b> 347V	
	24	250/400W wired 400W		<b>480</b> 480V	
			<b>RN</b> Reactor Normal Power Factor	<b>MT1</b> Multi-tap wired 120V	
			<b>RH</b> Reactor High Power Factor	<b>MT8</b> Multi-tap wired 208V	
			<b>XN</b> High Reactance (Lag) Normal Power Factor	<b>MT2</b> Multi-tap wired 240V	
			<b>XH</b> High Reactance (Lag) High Power Factor	<b>MT7</b> Multi-tap wired 277V	
			<b>CA</b> CWA	<b>TT1</b> Tri-tap wired 120V	
			<b>CT</b> CWI	<b>TT7</b> Tri-tap wired 277V	
			<b>MR</b> Mag Reg (3 Coil)	<b>TT3</b> Tri-tap wired 347V	
			<b>SC</b> SCWA	<b>DT1</b> Dual Tap 120/240 wired 120V	
			<b>XX</b> No Ballast	<b>DT2</b> Dual Tap 120/240 wired 240V	
				<b>DT3</b> Dual Tap 240/480 wired 240V	
				<b>DT4</b> Dual Tap 240/480 wired 480V	
Options					

Maximum number of options is six, for more options please contact your local American Electric Lighting representative

#### Mounting

(blank)	4-bolt Internal (standard)
<b>M2</b>	2-bolt Internal 2" setting
<b>2B</b>	2-bolt Internal 1-1/4" setting

#### Paint<sup>1</sup>

(blank)	Gray (standard)
<b>BK</b>	Black
<b>BZ</b>	Bronze
<b>WH</b>	White
<b>UP</b>	Unpainted

#### Terminal Block

(blank)	Terminal Block (standard)
<b>T2</b>	Wired to L1 & L2 Positions
<b>T3</b>	3 Wire Operation (L1, N, L2 Position) <sup>9</sup>

#### Listing

<b>UL</b>	UL Listed
<b>CS</b>	CSA Certified

#### Fusing<sup>2</sup>

<b>SF</b>	Single Fuse (120, 277, 347V)
<b>DF</b>	Double Fuse (208, 220, 240, 480V)

#### Photocontrol Receptacle

(blank)	NEMA Photocontrol Receptacle (standard)
<b>NR</b>	No Photocontrol Receptacle <sup>3</sup>
<b>PB</b>	Phosphor Bronze Contacts

#### Lamp

<b>LC</b>	Lamp Included, Clear
<b>LD</b>	Lamp Included, Deluxe/Coated
<b>LG</b>	Self-Igniting Lamp <sup>4</sup>

#### Starter<sup>5</sup>

(blank)	Open Board (standard)
<b>EC</b>	Encapsulated Plug-in
<b>OP</b>	Open Plug-in
<b>SN</b>	No Ignitor (use self-igniting lamp)

#### Misc.

<b>PC</b>	Photocontrol Included per Voltage Specified
<b>BL</b>	Bubble Level
<b>SS</b>	Stainless Steel Fasteners (external)
<b>CF</b>	Charcoal Filter
<b>PL</b>	Distribution Pattern Indicator Label
<b>LA</b>	Lightning Arrestor (Void UL/CSA Certified Options)
<b>5H</b>	50 Hertz Ballast Cycle <sup>6</sup>
<b>NN</b>	No NEMA Label on Housing
<b>SH</b>	Shorting Cap
<b>LCU</b>	Low Copper Alloy Content (less than 1%)
<b>HK</b>	Hinge Keeper
<b>HP</b>	High Performance <sup>7</sup>
<b>BF</b>	Bridge Fitter <sup>8</sup>

#### Notes:

- Other colors available, please contact your local American Electric Lighting representative
- voids UL/CSA Certified Options; not available with MT, TT, DT voltages
- PB, PC, SH, not available in NR option
- Requires SN option
- Available in HPS only
- Limited availability, please contact your local American Electric Lighting representative
- Available with FG optics only, Mogul base socket mounted on street side of reflector
- Tested to withstand 3G vibration, 4B standard required
- Not available for 120v fixtures

#### Optic Distribution

	R2SG	R3SG	R2FG	R3FG	R2 FG HP	R3 FG HP
<b>20S</b>	◆	◆	◆	◆	◆	◆
<b>25S</b>	◆	◆	◆	◆	◆	◆
<b>31S</b>	◆	◆	◆	◆	◆	◆
<b>40S</b>	◆	◆	◆	◆	◆	◆
<b>17M</b>	-	-	◆	◆	-	-
<b>25M</b>	-	-	◆	◆	-	-
<b>40M</b>	◆	◆	-	-	-	-
<b>17V</b>	-	-	◆	◆	-	-
<b>25V</b>	-	-	◆	◆	-	-
<b>40V</b>	◆	◆	-	-	-	-



An Acuity Brands Company

#### American Electric Lighting

Acuity Lighting Group, Inc.

1335 Industrial Boulevard, Conyers, GA 30012

Phone: 800-754-0463 Fax: 770-860-3255

www.americanelectriclighting.com